

model

60310

SINGLE - POINT PLATFORM LOAD CELL



FEATURES :

- ❖ Tool Steel Construction for Harsh Application
- ❖ Low Profile
- ❖ Single Point Capability with minimum error for off-centre loading
- ❖ Supports Platform Scale with size 600 x 600 (mm)
- ❖ Compact, Light Weight & Economical

APPLICATIONS :

- ❖ Smaller Sized Economical Platform Scales
- ❖ Check Weighers
- ❖ Bag Weighers

DESCRIPTION :

This is a strain Gage based low profile bending beam Load Cell for platform size of 600 x 600 (mm). It is an economical cell for smaller size low profile platform scales. It is off center load compensated and is rugged to take shock loads.

PERFORMANCE SPECIFICATION :

Standard Capacities (Kgf.)	: 75, 100, 120, 150, 200, 250, 300, 400
Excitation Voltage	: 10 VDC - Maximum 15 VDC
Nominal Output	: 2.0 mV/V
Non - Linearity	: < ± 0.025 % FSO (Full Scale Output)
Hysteresis	: < ± 0.01 % FSO
Non - Repeatability	: < ± 0.02 % FSO
Creep (30 minutes)	: < ± 0.03 % FSO
Zero Balance	: ± 1.0 % FSO
Input resistance	: 390 ± 15 Ohms
Output Resistance	: 350 ± 5 Ohms
Insulation Resistance	: > 1000 Mega Ohms
Safe Overload	: 150% of Rated Capacity
Ultimate Overload	: 250 % of Rated Capacity
Temperature	: 0-60° C
Compensated Range	
Temperature Effect on Output	: < 0.0015 % FSO/° C
Temperature Effect on Zero	: < 0.0020 % FSO/° C
Platter Size	: 600 x 600 mm
Eccentric Load Effect	: < 0.02% of FSO at 1/3 rated load placed within 300mm radius from the center of Load Cell
Deflection	: < 0.5 mm at FSO
Tightening Torque	: 5 m. kg.
Finish & Construction	: Electroless Nickel plated Tool Steel
Environmental Protection Class	: IP65



ADI ARTECH
TRANSDUCERS PVT. LTD.

A Joint venture with
ARTECH INDUSTRIES INC., U.S.A.



ELECTRICAL TERMINATION

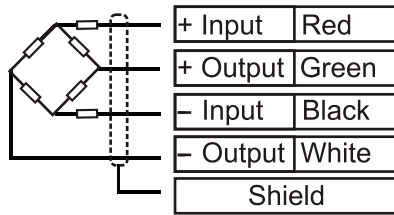

4 CORE SCREENED CABLE - 3 mtrs.

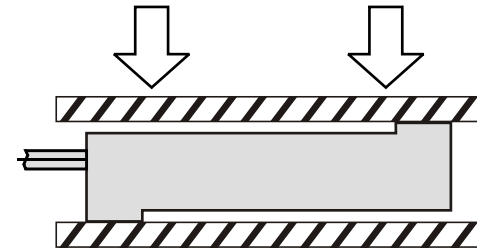

M8 X 16 DEEP (9 PLACES)

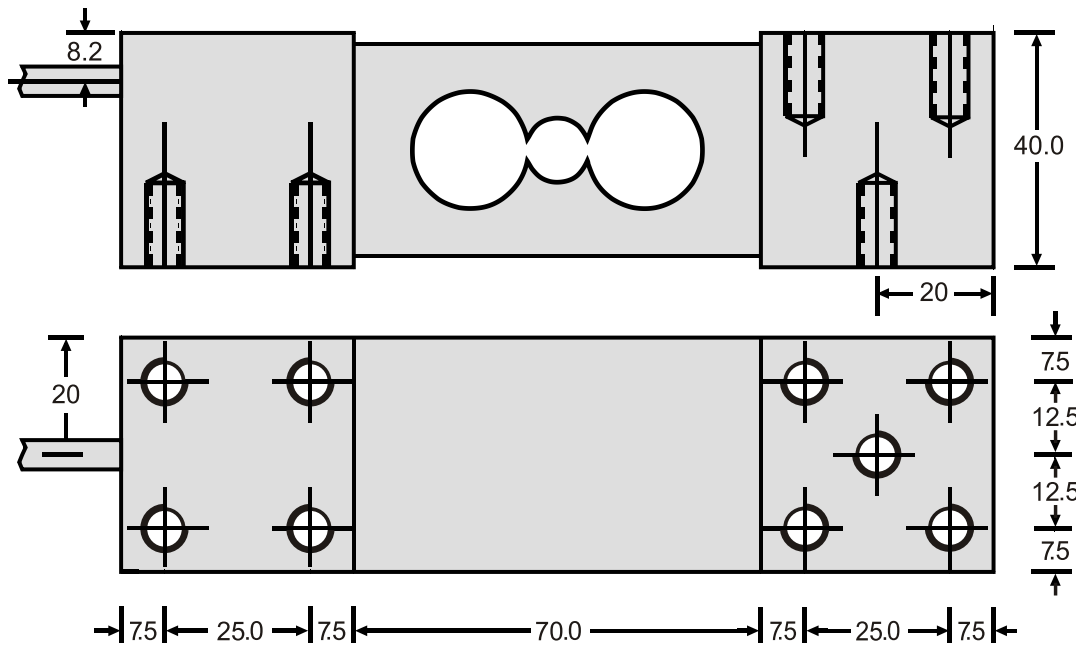

TOP VIEW

All dimensions are in mm.



SEEGATE CORPORATION

Swastik House , Building No.382 , 3rd Floor,
Room No.7 , Near Lamington Road Police
Station , Grant Road (E) . Mumbai -400007.

Tel - 022-40044443 Mobile - 7021525891 , 797338650

Email - sales@seegatecorp.com. Website - www.seegateloadcell.com

For more reference visit our website :- www.seegatecorp.in

