

## Parallel Beam Load Cells

Model:CZL642

### CAPACITY:

50kg-500kg

### Features:

Alloy Aluminum material,,good quality, high accuracy and low costs

Silicon adhesive sealed, surface anodized.

### APPLICATIONS:

Bench scales, platform scales and other electronic weighing devices

### Dimensions:mm

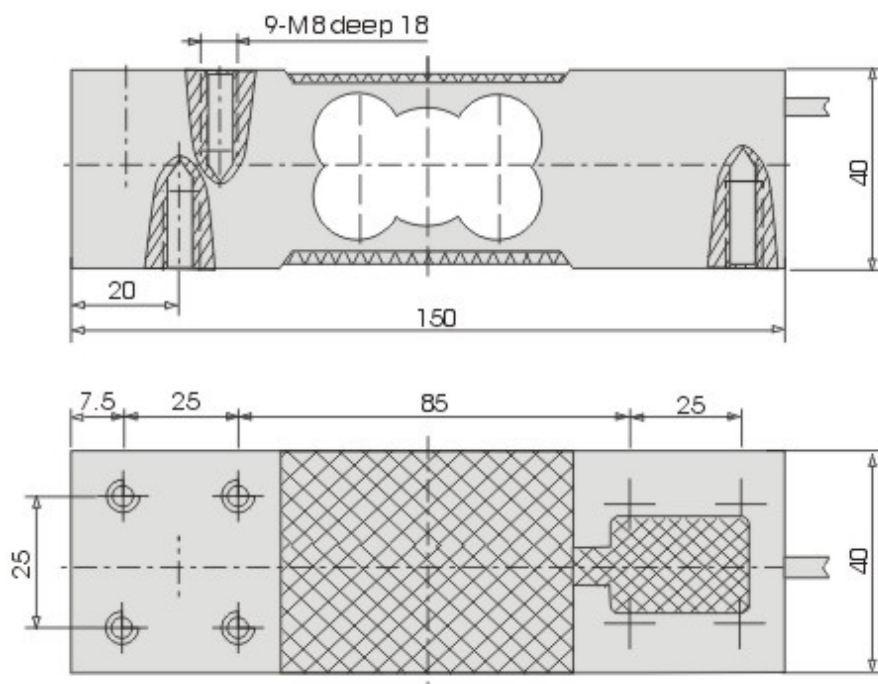

Parameters:

Precision:	C2 / C3
Rated Output:	2mv/v±0.1
Creep(%F.S/30min):	±0.02
Zero balance(%F.S):	±1.0
Input resistance:	405±10
Output resistance:	350±3
Insulation resistance:	≥5000(100VDC)
Temp. effect on span(%F.S/10°C):	±0.02
Temp. effect on zero(%F.S/10°C):	±0.02
Use temp. range(°C):	-20~+55
Excitation voltage(V) : :	9~12(DC)
Safety overload (%F.S)	120%
Ultimate overload (%F.S)	150%
Defend grade	IP65
Cable Length:	2 meters -6 meters