

model

# 30510

## ROPE TENSION LOAD CELL

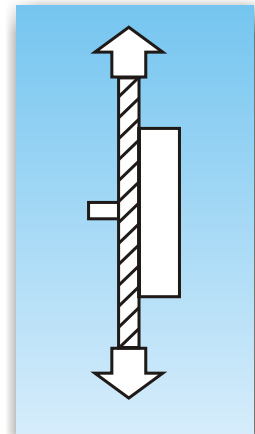
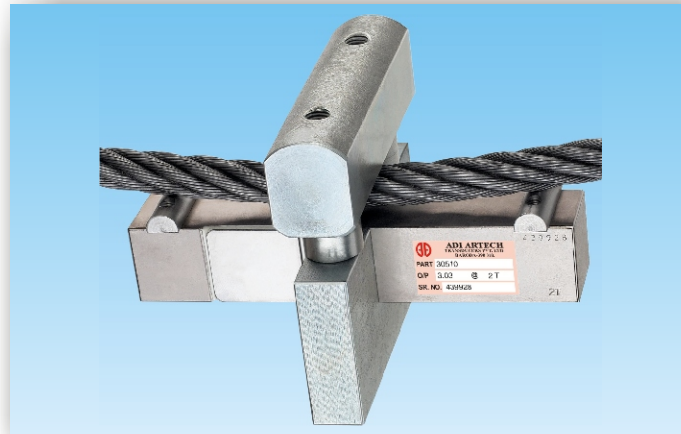

### FEATURES :

- ❖ 0.5 Tf to 7.5 Tf capacities load cells are offered for rope tension ranging from 1Tf to 50 Tf
- ❖ Complete environmental protection IP-65 class.
- ❖ Standard output 1.0mV/V available
- ❖ can be provided to accommodate multirope applications - up to 4 ropes

### APPLICATIONS :

- ❖ Elevator load monitor.
- ❖ Specially designed for protecting cranes and hoists from overload.
- ❖ Tension measurement in stay ropes, suspension ropes and railway catenary ropes.
- ❖ Vehicle pull test.
- ❖ Ship Bollard pull test.

### DESCRIPTION :

- ❖ This is used in industrial applications where the tension in wire rope needs to be carefully and continuously monitored and prevent overload.
- ❖ The load cell is conveniently clamped-on to the rope in existing condition.
- ❖ Designed to handle rope dia from 8mm to 80mm.

### PERFORMANCE SPECIFICATION :

<b>Standard Capacities (Tf.)</b>	: 0.5,1,2,3,5,7.5
<b>Excitation Voltage</b>	: 10 VDC - Maximum 15 VDC
<b>Nominal Output</b>	: 1 mV/V
<b>Non - Linearity</b>	: < ± 5.0 % FSO for range upto 20% < ± 2.0 % FSO for range above 20%
<b>Hysteresis</b>	: < ± 0.1 % FSO (Full Scale Output)
<b>Non-Repeatability</b>	: < ± 0.1% FSO
<b>Creep (30 minutes)</b>	: < ± 0.03 % FSO
<b>Input Resistance</b>	: 390 Ohms
<b>Output Resistance</b>	: 350 Ohms
<b>Insulation Resistance (50V)</b>	: > 1000 Mega Ohms
<b>Cable Length (4 core)</b>	: Upto 2T-5 M, Above 2T-10M
<b>Safe Overload</b>	: 150 % of Rated Capacity
<b>Ultimate Overload</b>	: 300 % of Rated Capacity
<b>Temp. Compensated Range</b>	: 0-60 °C
<b>Temp. Effect on Output</b>	: < 0.005 % FSO/ °C
<b>Temp. Effect on Zero</b>	: < 0.005 % FSO/ °C
<b>Deflection</b>	: < 0.5 mm at FSO
<b>Material of Construction</b>	: Tool Steel
<b>Environmental Protection Class</b>	: IP65



**ADI ARTECH**  
TRANSDUCERS PVT. LTD.

A Joint venture with  
ARTECH INDUSTRIES INC., U.S.A.



**ELECTRICAL TERMINATION**

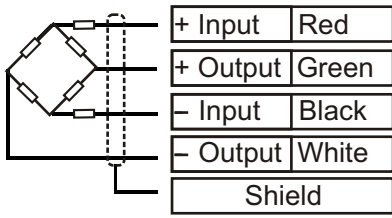

4 CORE SCREENED CABLE

Rope Tension (Tons)	Recommended Load Cell Capacity (Tons)	Rope dia - D	A	B	C	E
1,2,5	0.5	8-16	32	32	172	7.5
5,10	1	24-36	32	32	172	7.5
15	2	up to 40	32	32	172	7.5
25	3	up to 60	38	38	228	7.5
40	5	up to 72	38	38	228	7.5
50	7.5	up to 80	50	50	300	7.5

All dimensions are in mm.

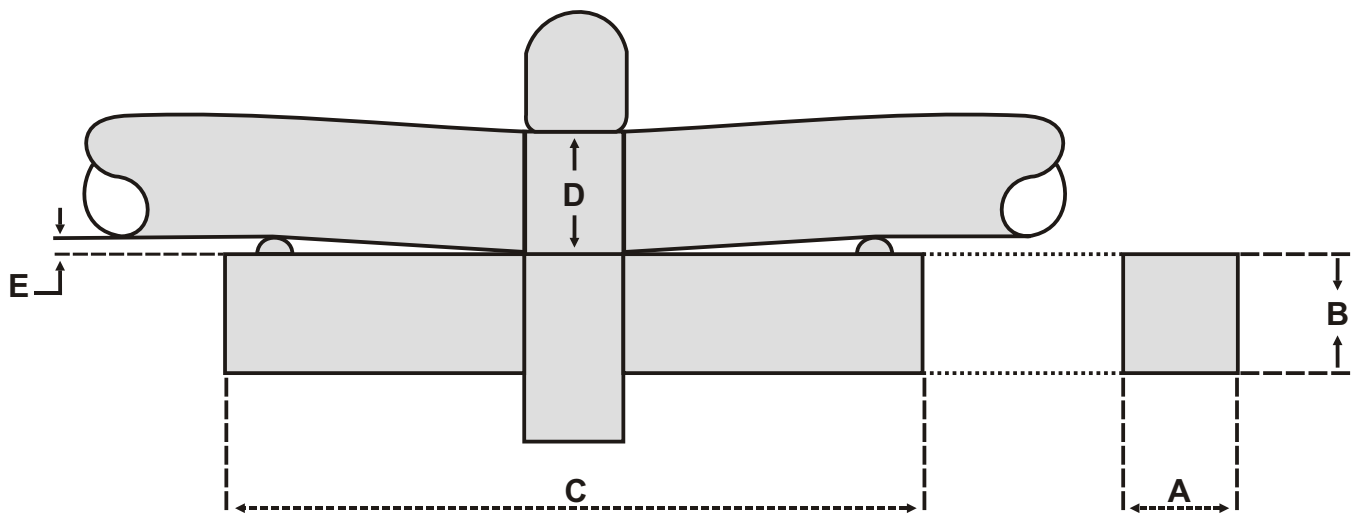

**SEEGATE CORPORATION**

Swastik House , Building No.382 , 3rd Floor,  
Room No.7 , Near Lamington Road Police  
Station , Grant Road (E) . Mumbai -400007.

Tel - 022-40044443 Mobile - 7021525891 , 797338650

Email -[sales@seegatecorp.com](mailto:sales@seegatecorp.com). Website - [www.seegateloadcell.com](http://www.seegateloadcell.com)